

## Set up live TV

1. Go to the Google Playstore and login with your Google account, or create a new account.
2. Search for "ProgTV" & install this app.
3. Then open the app.
4. Press IPTV Client



5. At playlist, enter your code completely, for example `http://watchtiptv.eu.streamtv.example` (press OK to open the keyboard)



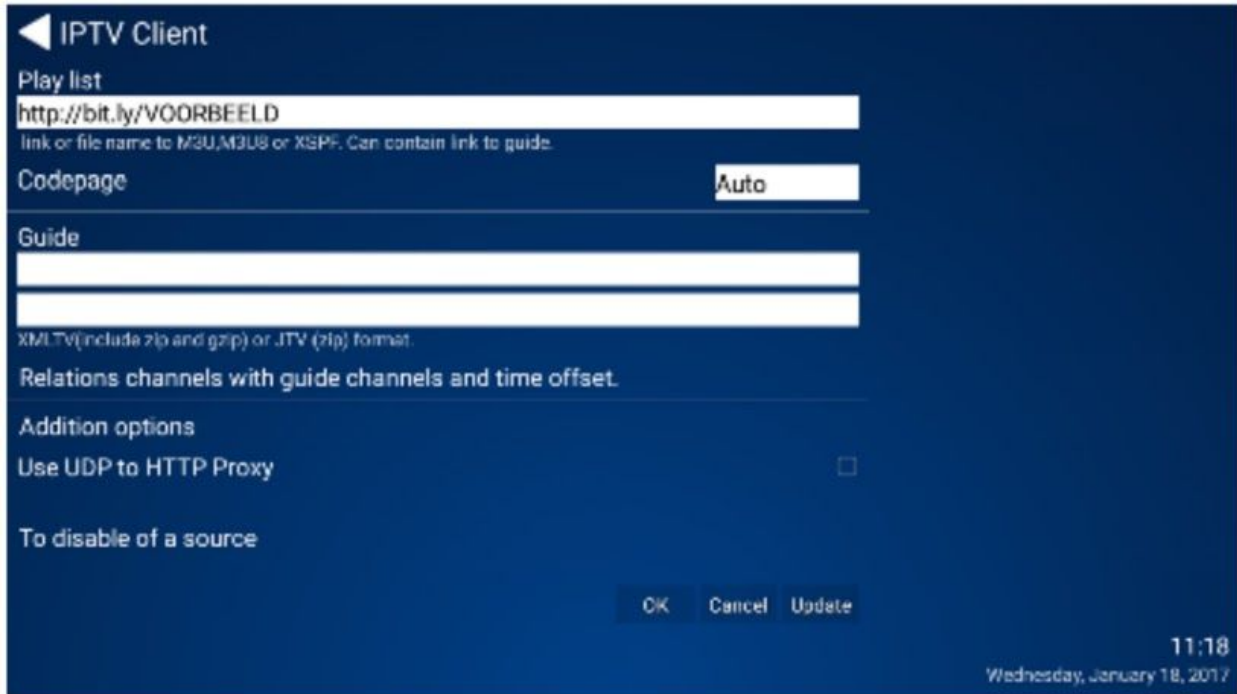

## Set up live TV

6. Press the "rotated arrow" to remove the keyboard & press OK
7. Press the "turned arrow" again
8. You will now find all channels via "channel list".

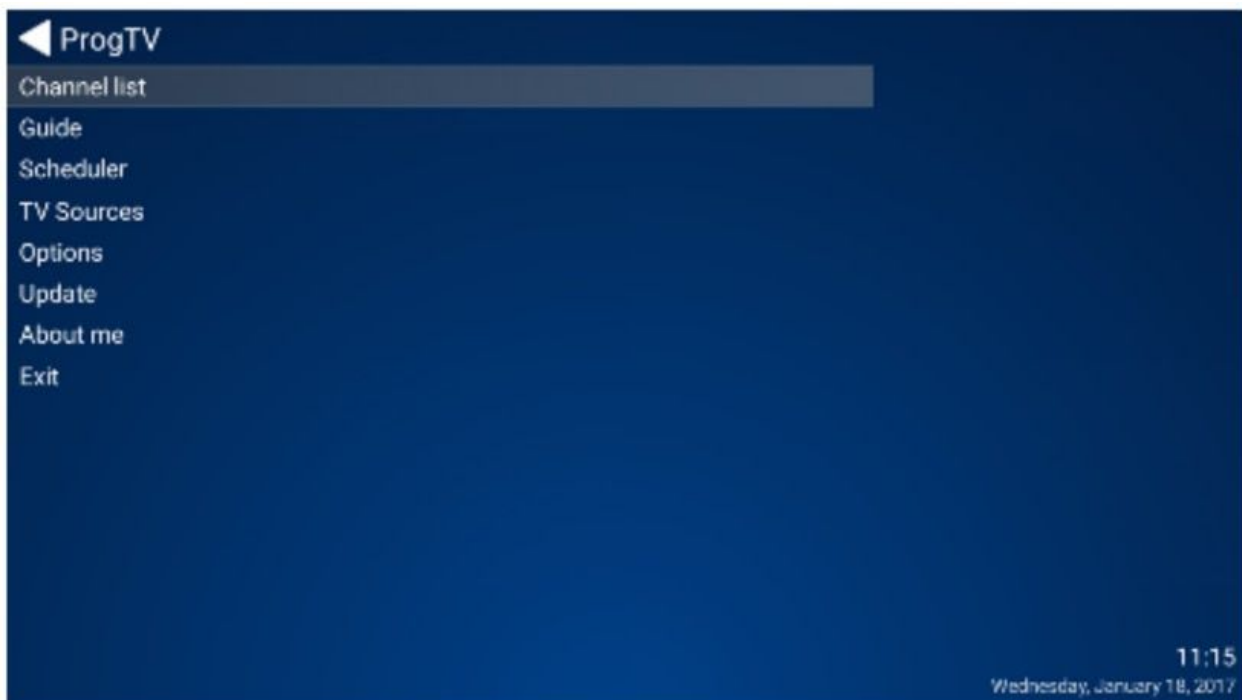

9. DMV. arrow up / low or left / right scroll through the channel list, sorted by country.
10. During playback you can go back to the list via the “rotated arrow”. You can also zap between channels using the up / down arrow.
11. If you want to return to the complete channel list or settings during playback, press the “rotated arrow” and then the “triangle” in the top left of the screen.

## Enjoy watching!

*Problems with the sound or the image? Then try the following;*

*Press options & then engine*

*And select different combinations under “Playback way”; these usually solve these problems immediately.*

